

The information contained in this drawing is the sole property of CWS Coil Winding Specialist. Any reproduction in part or whole without written permission of CWS Coil Winding Specialist is prohibited.

REVISION HISTORY

REV	ECN	DESCRIPTION	SIGN & DATE	DATE
A		PRE-PRODUCTION RELEASE	TKK 4/18/04	4/12/04

VERTICAL CONFIGURATION

.44 [11.18]

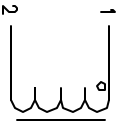

SCHEMATIC

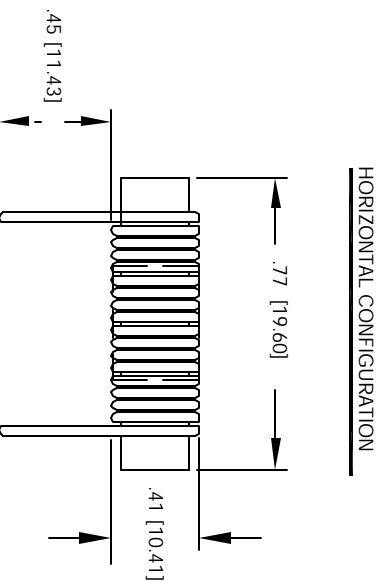
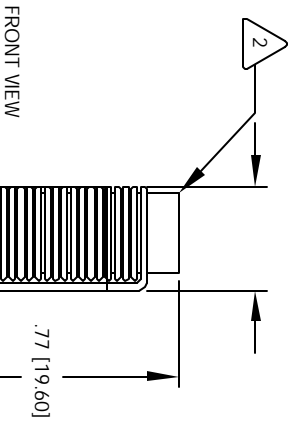

- LEADS MUST BE TANGENT TO THE CORE FLUSH WITH THE CORE EDGE, AS SHOWN

- REMOVE INSULATION AND TIN LEADS

- WIND COILS EVENLY SPACED
- CONSTRUCTION:
- HI-POT TEST FOR CORE TO WINDING = 500 VDC
- DCR = 9.5 MILLI-OHMS @ 25 °C
- L = 5.6 UH ± 20% , 1 KHZ, 0.25 Vrms, 0 ADC;
- SPECIFICATIONS: MAX DC CURRENT = 7 AMPS

- WIRE: UL RECOGNIZED 130° RATED MAGNET WIRE
- CWS BYTEMARK OR OTHER APPROVED PART
- CORE: MANGANESE ZINC FERRITE ROD

- RATING CLASS B (130°) REQUIRED
  - MATERIAL: WIRE INSULATION - UL RECOGNIZED 94V-0 FOR FLAMMABILITY
- NOTES: UNLESS OTHERWISE SPECIFIED, POWER INDUCTOR, DIMENSIONS IN INCHES [MM]

MOUNTING HOLES PATTERN

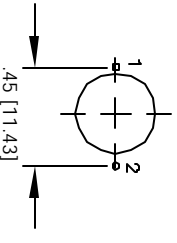

MOUNTING HOLES PATTERN

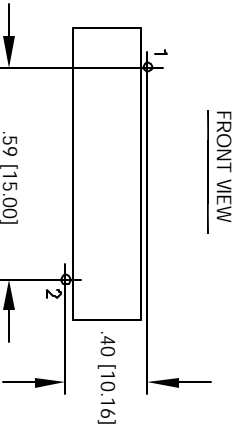

UNLESS OTHERWISE SPECIFIED	
TOLERANCING AND TOLERANCE PER ANSI Y14.5M AND [DIMENSIONS]	
ALL DIMENSIONS ARE IN NOTES	
TOLERANCE INCHES	±.0030
TOLERANCE METERS	±.0750
ANGLE PROJECTION	2ND ANGLE
DO NOT SCALE DRAWING	

CODE IDENT	MFG. P/N	DESCRIPTION	ITEM NO.
		PARTS LIST	

AUTOCAD SOLIDWORKS SIGN	DATE	CWS Coil Winding Specialist www.cwswind.com	1510 E. Edinger Ave. Unit B, Santa Ana, CA 92705
-------------------------	------	--	---

TITLE:	Power Chokes	
DRAWN	TKK	
CHKD	JLU	
ENGR	KSUN	
APPR	JLU	
DATE	4/12/04	
SIZE	DATE	REV
B	4/12/04	A
SCALE	2=1	
		SHEET 1 OF 1